

DEPARTMENT OF TRANSPORTATION

DISTRICT 8
OFFICE OF RIGHT OF WAY
464 W. 4TH STREET, MS-950
SAN BERNARDINO, CA 92401
PHONE (909) 888-4690
FAX (909) 388-6877
TTY (909) 383-6300



*Making Conservation
a California Way of Life.*

July 27, 2018

Vincent Mammano, California Division Administrator
Federal Highway Administration
650 Capital Mall, Suite 4-100
Sacramento, CA 95814

08-SBD-058-P.M. 6.27-6.78 and 7.76-8.85
Parcel No's. 21064-1 and 21080-1
E.A. 0E850
Federal Public Land Deed of Conveyance

Attention: Joseph Vaughn, Realty Specialist

The Department of Transportation requested a D.O.T. Federal Public Land Deed of Conveyance from the United States Department of the Interior, Bureau of Land Management (BLM), pursuant to U.S.C. Title 23; Highways, Section 317 and Section 107(d) requesting the appropriation of public lands of the United States within the State of California for the purpose of issuing a right-of-way use document to construct, operate, maintain, and terminate a widening of the median on State Route 58, adding rumble strips, widen and upgrade shoulders, and extend drainage, which contains 18.768 acres.

Enclosed please find the Letter of Consent and a final draft of the highway easement deed that needs to be executed after your review for sufficiency. Enclosed you will also find the ten stipulations found on the body of the deed as well as attached to the Letter of Consent. They have been reviewed by our office and found acceptable.

Once your review has been completed we ask that the deed be forwarded to the FHWA office, attention Joseph Vaughn, for further processing. Thank you.

Should you need additional documentation to aid in this review, aside from the enclosed, let me know and I will send the documents to you electronically:

- Copies of the recorded application maps.
- Copies of the Initial Study with Mitigated Negative Declaration/Environmental Assessment and Initial Site Assessment Checklist.

Once the deed has been executed, we ask that it be returned to:

Thomas O'Neil
Senior Right of Way Agent
Office of Project Delivery
Division of Right of Way & Land Surveys
Caltrans Headquarters
1120 N Street, MS 37
Sacramento, CA 95814

If you have any questions about this request or the deed, I can be reached at (909) 888-4690 or via email at Aidee.Arpon@dot.ca.gov .

Sincerely,



Aidee Arpon
Associate Right of Way Agent
And Federal Lands Coordinator
District 8 Office of Right of Way, Acquisitions

Enclosures

RECORDING REQUESTED BY

When Recorded Mail To

STATE OF CALIFORNIA
DEPARTMENT OF TRANSPORTATION
464 W. 4th STREET, 6th FLOOR
SAN BERNARDINO, CA 92401-1400
Attention Record Maps- MS 980

FREE RECORDING:

This instrument is for the benefit of The State of California, and is entitled to be recorded without fee or tax. (Govt. Code 6103, 27383 and Rev. & Tax Code 11922)

Space above this line for Recorder's Use

**HIGHWAY EASEMENT
DEED
(New Construction)**

District	County	Route	Postmile	Number
08	SBd	58	6.27-6.78 7.76-8.85	21064-1 & 21080-1

This Deed is made on _____, 20 , by and between the United States of America, acting by and through the Department of Transportation, Federal Highway Administration (GRANTOR), and the State of California, Department of Transportation (GRANTEE).

RECITALS

1. GRANTEE has filed an application under the provisions of the Act of Congress of August 27, 1958, as amended (23 U.S.C. Section 317 and/or Section 107(d)), for the right-of-way of a highway over certain federal land in the State of California under the jurisdiction of the United States Department of the Interior, Bureau of Land Management (FEDERAL AGENCY), which land has been appropriated by GRANTOR.
2. The Federal Highway Division Administrator, pursuant to delegation of authority from the Secretary of Transportation and Federal Highway Administrator, has determined that an easement over the federal land covered by the application is reasonably necessary for a right-of-way for the construction, operation and maintenance of State Route 08 SBd 58, post mile 6.27-6.78 and 7.76-8.85.
3. FEDERAL AGENCY, in its consent to the appropriation of the federal land, has agreed to the transfer by GRANTOR of an easement over the federal land to GRANTEE.
4. GRANTEE, with respect to activities related to the federal land, agrees that (a) no person shall, on the grounds of race, color, national origin, sex, age, disability, or religion be excluded from participation in, be denied the benefits of, or be otherwise subjected to discrimination with regard to the GRANTEE's operations, programs, or activities conducted on the federal land; and (b) GRANTEE shall use the federal land so conveyed in compliance with all requirements imposed by or pursuant to Title VI of the Civil Rights Act of 1964 (42 U.S.C. Section 2000d to 2000d-4) and all applicable civil rights provisions of other Federal statutes.

NOW THEREFORE, GRANTOR does hereby grant to GRANTEE an easement for a right-of-way for the construction, operation, and maintenance of a highway and use of the space above and below the established grade line of the

Number
21064-1 & 21080-1

highway pavement for highway purposes on, over, across, in, and upon the following described federal land in the County of San Bernardino, State of California described as:

DESCRIPTION

Township 10 North, Range 6 West, SAN BERNARDINO MERIDIAN, according to the U.S. Government Plat approved January 12, 1857 and the Supplemental U.S. Government Plat for Section 4 approved July 24, 1957.

<u>Section</u>	<u>Subdivision</u>
2	S ½ SW ¼
3	N ½ SE ¼
4	Lots 119-130, N ½ N ½ N ½ SW ¼

The land described above is depicted on Exhibit "A," attached and made a part hereof, and shown as Parcel Number(s) 21064-1 and 21080-1 on Sheets 1 through 4, recorded on September 16, 2010 as Document No. 2010-0380074 in Book 17, Pages 36 through 39 of State Highway Maps in the Office of the County Recorder of said County.

The attached real property description has been prepared by me, or under my direction, in conformance with the Professional Land Surveyors' Act in the State of California.

Signature

Professional Land Surveyor

Date

11/13/18



Number
21064-1 & 21080-1

This transfer is subject to the following terms and conditions:

1. If outstanding valid claims exist on the date of this use authorization, the State agency shall obtain such permission as may be necessary on account of any such claims.
2. The use right herein authorized is limited to the described right-of-way and the space above and below for highway purposes and does not include any use rights for non-highway purposes.
3. Retention of rights by BLM to use, or authorize use on, any portion of the right-of-way for non-highway purposes provided such use would not interfere with the free flow of traffic, impair the full use and safety of the highway, or be inconsistent with the provisions of Title 23 of the United States Code and the FHWA regulations pursuant thereto, and the FHWA and the State agency concerned shall be consulted prior to exercising such rights.
4. The use right herein authorized shall terminate 10 years, or sooner if agreed upon, from the date of execution of the transfer document by FHWA to the State in the event construction of a highway or use of the material site has not been initiated during such period.
5. Location by BLM of any Bureau information signs on the portions of the right-of-way outside of construction clearing limits except that such signs shall not be located on the right-of-way of an Interstate System.
6. Consistent with highway safety standards, the State agency shall:
 - a. Protect and preserve soil and vegetative cover and scenic and aesthetic values on the right-of-way outside of construction limits.
 - b. Provide for the prevention and control of soil erosion within the right-of-way and adjacent lands that might be affected by the construction, operation and maintenance of the highway.
 - c. Vegetate and keep vegetated with suitable species, all earth cut or fill slopes feasible for revegetation or other areas on which ground cover is destroyed where it is deemed necessary prior to completion of the highway and shall maintain terracing, water bars, leadoff ditches, or other preventive works that may be required to accomplish this objective. This provision shall also apply to slopes that are reshaped following slides which occur during or after construction.

8. Establish no sites for highway operation and maintenance facilities, camps, supply depot or disposal areas within the right-of-way, unless shown on approved construction plans, without obtaining approval of the BLM authorized Officer.
9. Application of chemicals shall be pursuant to the National Environmental Policy Act and shall be approved by FHWA prior to application by the State.
10. The provisions of Title VI of the Civil Rights Act of 1964 (78 Stat. 242) shall be complied with.

Number
21067-1 & 21080-1

I, Joanna Georgallis, Attorney at Law, State of California, Department of Transportation, am duly licensed to practice law in the State of California, and hereby certify that this deed is legally sufficient for its stated purpose.

Joanna Georgallis
Signature

August 7, 2018
Date

IN WITNESS WHEREOF, I, _____, Division Administrator, pursuant to delegations of authority from the Secretary of Transportation and the Federal Highway Administrator, by virtue of authority in me vested by law, have hereunto subscribed my name as of the day and year first above written.

UNITED STATES OF AMERICA
DEPARTMENT OF TRANSPORTATION
FEDERAL HIGHWAY ADMINISTRATION

By _____
California Division Administrator

THIS IS TO CERTIFY, that the State of California, acting by and through the Department of Transportation (pursuant to Section 27281 of the Government Code), accepts for public purposes the real property described in this deed and consents to its recordation.

Dated: _____

Director of Transportation

By _____
Attorney in Fact

COUNTY OF SAN BERNARDINO

T 10 N, R 6 W, S.B.M.

ROUTE 395

EDWARDS AIR FORCE BASE

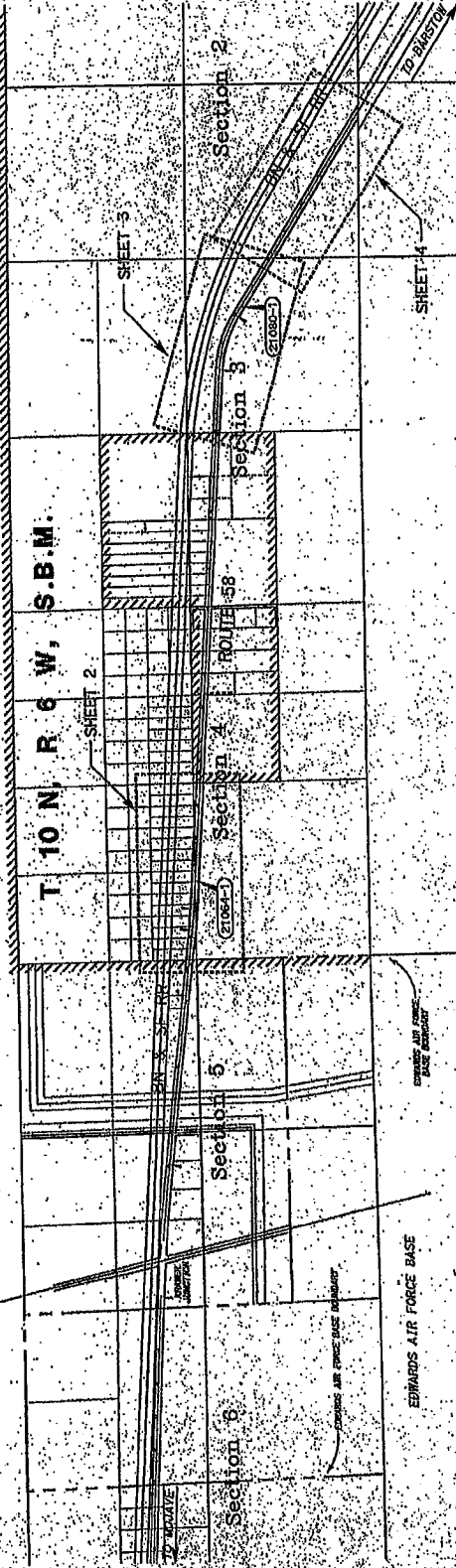

SURVEYOR'S STATEMENT
 I, the undersigned, being a duly qualified and licensed Surveyor in the State of California, do hereby certify that the foregoing is a true and correct copy of the original survey map and plat as the same appears on the records of the County of San Bernardino, California, and that the same is a true and correct copy of the original survey map and plat as the same appears on the records of the County of San Bernardino, California, and that the same is a true and correct copy of the original survey map and plat as the same appears on the records of the County of San Bernardino, California.

CAC
 PROFESSIONAL LAND SURVEYOR
 DATE 9/15/10



RIGHT OF WAY APPLIED FOR OVER AND ACROSS
 THE FOLLOWING UNPATENTED PUBLIC LANDS:

SECTIONS 2, 3, AND 4, T. 10 N., R. 6 W., S.B.M.

SAN BERNARDINO COUNTY RECORDER'S CERTIFICATE

THIS MAP WAS FILED FOR RECORD IN THE OFFICE OF THE COUNTY CLERK OF THE COUNTY OF SAN BERNARDINO, CALIFORNIA, ON MAY 24, 2010, AT 10:00 A.M., IN BOOK 17, PAGE 17, OF THE PUBLIC RECORDS OF THE COUNTY OF SAN BERNARDINO, CALIFORNIA.

RIGHT OF WAY APPROVED PER LETTER OF CONSENT
 DATED MAY 24, 2010 BY BOBIE C. TROST, FIELD MANAGER,
 BOSTON FIELD OFFICE OF THE BUREAU OF LAND
 MANAGEMENT, DEPARTMENT OF THE INTERIOR, BOSTON,
 CALIFORNIA TO YONKENT AND OFFICE OF THE FEDERAL
 HIGHWAY ADMINISTRATION

LESTY MILLER
 COUNTY CLERK
 COUNTY OF SAN BERNARDINO

FEDERAL APPLICATION INDEX MAP
 Bureau of Land Management
 MAP NO. RW000027-01

SECTION	ACRES	ADJACENT LANDS
2	160.00	TO BOSTON
3	160.00	TO BOSTON
4	160.00	TO BOSTON
5	160.00	TO BOSTON
6	160.00	TO BOSTON

EXHIBIT A

1	2	3	4	5	6	7	8	9	10	11	12	13	14	15	16	17	18	19	20	21	22	23	24	25	26	27	28	29	30	31	32	33	34	35	36	37	38	39	40	41	42	43	44	45	46	47	48	49	50	51	52	53	54	55	56	57	58	59	60	61	62	63	64	65	66	67	68	69	70	71	72	73	74	75	76	77	78	79	80	81	82	83	84	85	86	87	88	89	90	91	92	93	94	95	96	97	98	99	100
1	2	3	4	5	6	7	8	9	10	11	12	13	14	15	16	17	18	19	20	21	22	23	24	25	26	27	28	29	30	31	32	33	34	35	36	37	38	39	40	41	42	43	44	45	46	47	48	49	50	51	52	53	54	55	56	57	58	59	60	61	62	63	64	65	66	67	68	69	70	71	72	73	74	75	76	77	78	79	80	81	82	83	84	85	86	87	88	89	90	91	92	93	94	95	96	97	98	99	100

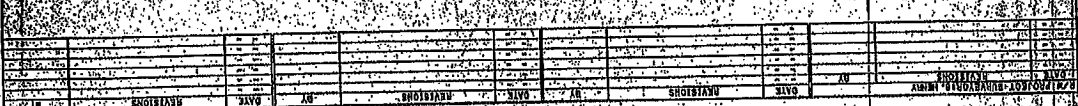
[illegible]

FEDERAL APPLICATION MAP
Bureau of Land Management
MAP NO. RY660027-02

MAP NO. RY000027-02

OFFICE OF THE ATTORNEY GENERAL
STATE OF TEXAS
JULY 1, 1900

1-DATE	1-DATE
R/S/PRO	R/S/PRO

GOVT LOT 1

出

GOVERNMENT LAND

GOVERNMENT LAND.

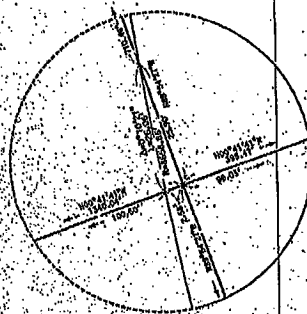

DETAIL "A"

NO SCALE

STATE OF CALIFORNIA.

TRANSPORTATION AND EDITING AGENCY -

RECEIVED BY THE DIRECTOR, FBI, 11/11/64

APPLICATION MAP

of Land Management

1990

NO. RW000027-03

Figure 1

SCALE = 1:10000

2025年1月1日

DATE	SHEET NO.	TOTAL SHEETS

58.	-7.767822	21.3.21	21.3.21	21.3.21
-----	-----------	---------	---------	---------

1	2	3	4	5	6	7	8	9	10	11	12	13	14	15	16	17	18	19	20	21	22	23	24	25	26	27	28	29	30	31	32	33	34	35	36	37	38	39	40	41	42	43	44	45	46	47	48	49	50	51	52	53	54	55	56	57	58	59	60	61	62	63	64	65	66	67	68	69	70	71	72	73	74	75	76	77	78	79	80	81	82	83	84	85	86	87	88	89	90	91	92	93	94	95	96	97	98	99	100
---	---	---	---	---	---	---	---	---	----	----	----	----	----	----	----	----	----	----	----	----	----	----	----	----	----	----	----	----	----	----	----	----	----	----	----	----	----	----	----	----	----	----	----	----	----	----	----	----	----	----	----	----	----	----	----	----	----	----	----	----	----	----	----	----	----	----	----	----	----	----	----	----	----	----	----	----	----	----	----	----	----	----	----	----	----	----	----	----	----	----	----	----	----	----	----	----	----	----	-----

1997, 1998, 1999, 2000, 2001, 2002, 2003, 2004, 2005, 2006, 2007, 2008, 2009, 2010, 2011, 2012, 2013, 2014, 2015, 2016, 2017, 2018, 2019, 2020, 2021, 2022, 2023, 2024, 2025, 2026, 2027, 2028, 2029, 2030, 2031, 2032, 2033, 2034, 2035, 2036, 2037, 2038, 2039, 2040, 2041, 2042, 2043, 2044, 2045, 2046, 2047, 2048, 2049, 2050, 2051, 2052, 2053, 2054, 2055, 2056, 2057, 2058, 2059, 2060, 2061, 2062, 2063, 2064, 2065, 2066, 2067, 2068, 2069, 2070, 2071, 2072, 2073, 2074, 2075, 2076, 2077, 2078, 2079, 2080, 2081, 2082, 2083, 2084, 2085, 2086, 2087, 2088, 2089, 2090, 2091, 2092, 2093, 2094, 2095, 2096, 2097, 2098, 2099, 2100, 2101, 2102, 2103, 2104, 2105, 2106, 2107, 2108, 2109, 2110, 2111, 2112, 2113, 2114, 2115, 2116, 2117, 2118, 2119, 2120, 2121, 2122, 2123, 2124, 2125, 2126, 2127, 2128, 2129, 2130, 2131, 2132, 2133, 2134, 2135, 2136, 2137, 2138, 2139, 2140, 2141, 2142, 2143, 2144, 2145, 2146, 2147, 2148, 2149, 2150, 2151, 2152, 2153, 2154, 2155, 2156, 2157, 2158, 2159, 2160, 2161, 2162, 2163, 2164, 2165, 2166, 2167, 2168, 2169, 2170, 2171, 2172, 2173, 2174, 2175, 2176, 2177, 2178, 2179, 2180, 2181, 2182, 2183, 2184, 2185, 2186, 2187, 2188, 2189, 2190, 2191, 2192, 2193, 2194, 2195, 2196, 2197, 2198, 2199, 2200, 2201, 2202, 2203, 2204, 2205, 2206, 2207, 2208, 2209, 2210, 2211, 2212, 2213, 2214, 2215, 2216, 2217, 2218, 2219, 2220, 2221, 2222, 2223, 2224, 2225, 2226, 2227, 2228, 2229, 2230, 2231, 2232, 2233, 2234, 2235, 2236, 2237, 2238, 2239, 2240, 2241, 2242, 2243, 2244, 2245, 2246, 2247, 2248, 2249, 2250, 2251, 2252, 2253, 2254, 2255, 2256, 2257, 2258, 2259, 2260, 2261, 2262, 2263, 2264, 2265, 2266, 2267, 2268, 2269, 2270, 2271, 2272, 2273, 2274, 2275, 2276, 2277, 2278, 2279, 2280, 2281, 2282, 2283, 2284, 2285, 2286, 2287, 2288, 2289, 2290, 2291, 2292, 2293, 2294, 2295, 2296, 2297, 2298, 2299, 2300, 2301, 2302, 2303, 2304, 2305, 2306, 2307, 2308, 2309, 2310, 2311, 2312, 2313, 2314, 2315, 2316, 2317, 2318, 2319, 2320, 2321, 2322, 2323, 2324, 2325, 2326, 2327, 2328, 2329, 2330, 2331, 2332, 2333, 2334, 2335, 2336, 2337, 2338, 2339, 2340, 2341, 2342, 2343, 2344, 2345, 2346, 2347, 2348, 2349, 2350, 2351, 2352, 2353, 2354, 2355, 2356, 2357, 2358, 2359, 2360, 2361, 2362, 2363, 2364, 2365, 2366, 2367, 2368, 2369, 2370, 2371, 2372, 2373, 2374, 2375, 2376, 2377, 2378, 2379, 2380, 2381, 2382, 2383, 2384, 2385, 2386, 2387, 2388, 2389, 2390, 2391, 2392, 2393, 2394, 2395, 2396, 2397, 2398, 2399, 2400, 2401, 2402, 2403, 2404, 2405, 2406, 2407, 2408, 2409, 2410, 2411, 2412, 2413, 2414, 2415, 2416, 2417, 2418, 2419, 2420, 2421, 2422, 2423, 2424, 2425, 2426, 2427, 2428, 2429, 2430, 2431, 2432, 2433, 2434, 2435, 2436, 2437, 2438, 2439, 2440, 2441, 2442, 2443, 2444, 2445, 2446, 2447, 2448, 2449, 2450, 2451, 2452, 2453, 2454, 2455, 2456, 2457, 2458, 2459, 2460, 2461, 2462, 2463, 2464, 2465, 2466, 2467, 2468, 2469, 2470, 2471, 2472, 2473, 2474, 2475, 2476, 2477, 2478, 2479, 2480, 2481, 2482, 2483, 2484, 2485, 2486, 2487, 2488, 2489, 2490, 2491, 2492, 2493, 2494, 2495, 2496, 2497, 2498, 2499, 2500, 2501, 2502, 2503, 2504, 2505, 2506, 2507, 2508, 2509, 2510, 2511, 2512, 2513, 2514, 2515, 2516, 2517, 2518, 2519, 2520, 2521, 2522, 2523, 2524, 2525, 2526, 2527, 2528, 2529, 2530, 2531, 2532, 2533, 2534, 2535, 2536, 2537, 2538, 2539, 2540, 2541, 2542, 2543, 2544, 2545, 2546, 2547, 2548, 2549, 2550, 2551, 2552, 2553, 2554, 2555, 2556, 2557, 2558, 2559, 2560, 2561, 2562, 2563, 2564, 2565, 2566, 2567, 2568, 2569, 2570, 2571, 2572, 2573, 2574, 2575, 2576, 2577, 2578, 2579, 2580, 2581, 2582, 2583, 2584, 2585, 2586, 2587, 2588, 2589, 2590, 2591, 2592, 2593, 2594, 2595, 2596, 2597, 2598, 2599, 2600, 2601, 2602, 2603, 2604, 2605, 2606, 2607, 2608, 2609, 2610, 2611, 2612, 2613, 2614, 2615, 2616, 2617, 2618, 2619, 2620, 2621, 2622, 2623, 2624, 2625, 2626, 2627, 2628, 2629, 2630, 2631, 2632, 2633, 2634, 2635, 2636, 2637, 2638, 2639, 2640, 2641, 2642, 2643, 2644, 2645, 2646, 2647, 2648, 2649, 2650, 2651, 2652, 2653, 2654, 2655, 2656, 2657, 2658, 2659, 2660, 2661, 2662, 2663, 2664, 2665, 2666, 2667, 2668, 2669, 2670, 2671, 2672, 2673, 2674, 2675, 2676, 2677, 2678, 26

1998, 1999, 2000, 2001, 2002, 2003, 2004, 2005, 2006, 2007, 2008, 2009, 2010, 2011, 2012, 2013, 2014, 2015, 2016, 2017, 2018, 2019, 2020, 2021, 2022, 2023, 2024, 2025, 2026, 2027, 2028, 2029, 2030, 2031, 2032, 2033, 2034, 2035, 2036, 2037, 2038, 2039, 2040, 2041, 2042, 2043, 2044, 2045, 2046, 2047, 2048, 2049, 2050, 2051, 2052, 2053, 2054, 2055, 2056, 2057, 2058, 2059, 2060, 2061, 2062, 2063, 2064, 2065, 2066, 2067, 2068, 2069, 2070, 2071, 2072, 2073, 2074, 2075, 2076, 2077, 2078, 2079, 2080, 2081, 2082, 2083, 2084, 2085, 2086, 2087, 2088, 2089, 2090, 2091, 2092, 2093, 2094, 2095, 2096, 2097, 2098, 2099, 2100, 2101, 2102, 2103, 2104, 2105, 2106, 2107, 2108, 2109, 2110, 2111, 2112, 2113, 2114, 2115, 2116, 2117, 2118, 2119, 2120, 2121, 2122, 2123, 2124, 2125, 2126, 2127, 2128, 2129, 2130, 2131, 2132, 2133, 2134, 2135, 2136, 2137, 2138, 2139, 2140, 2141, 2142, 2143, 2144, 2145, 2146, 2147, 2148, 2149, 2150, 2151, 2152, 2153, 2154, 2155, 2156, 2157, 2158, 2159, 2160, 2161, 2162, 2163, 2164, 2165, 2166, 2167, 2168, 2169, 2170, 2171, 2172, 2173, 2174, 2175, 2176, 2177, 2178, 2179, 2180, 2181, 2182, 2183, 2184, 2185, 2186, 2187, 2188, 2189, 2190, 2191, 2192, 2193, 2194, 2195, 2196, 2197, 2198, 2199, 2200, 2201, 2202, 2203, 2204, 2205, 2206, 2207, 2208, 2209, 2210, 2211, 2212, 2213, 2214, 2215, 2216, 2217, 2218, 2219, 2220, 2221, 2222, 2223, 2224, 2225, 2226, 2227, 2228, 2229, 2230, 2231, 2232, 2233, 2234, 2235, 2236, 2237, 2238, 2239, 2240, 2241, 2242, 2243, 2244, 2245, 2246, 2247, 2248, 2249, 2250, 2251, 2252, 2253, 2254, 2255, 2256, 2257, 2258, 2259, 2260, 2261, 2262, 2263, 2264, 2265, 2266, 2267, 2268, 2269, 2270, 2271, 2272, 2273, 2274, 2275, 2276, 2277, 2278, 2279, 2280, 2281, 2282, 2283, 2284, 2285, 2286, 2287, 2288, 2289, 2290, 2291, 2292, 2293, 2294, 2295, 2296, 2297, 2298, 2299, 2300, 2301, 2302, 2303, 2304, 2305, 2306, 2307, 2308, 2309, 2310, 2311, 2312, 2313, 2314, 2315, 2316, 2317, 2318, 2319, 2320, 2321, 2322, 2323, 2324, 2325, 2326, 2327, 2328, 2329, 2330, 2331, 2332, 2333, 2334, 2335, 2336, 2337, 2338, 2339, 2340, 2341, 2342, 2343, 2344, 2345, 2346, 2347, 2348, 2349, 2350, 2351, 2352, 2353, 2354, 2355, 2356, 2357, 2358, 2359, 2360, 2361, 2362, 2363, 2364, 2365, 2366, 2367, 2368, 2369, 2370, 2371, 2372, 2373, 2374, 2375, 2376, 2377, 2378, 2379, 2380, 2381, 2382, 2383, 2384, 2385, 2386, 2387, 2388, 2389, 2390, 2391, 2392, 2393, 2394, 2395, 2396, 2397, 2398, 2399, 2400, 2401, 2402, 2403, 2404, 2405, 2406, 2407, 2408, 2409, 2410, 2411, 2412, 2413, 2414, 2415, 2416, 2417, 2418, 2419, 2420, 2421, 2422, 2423, 2424, 2425, 2426, 2427, 2428, 2429, 2430, 2431, 2432, 2433, 2434, 2435, 2436, 2437, 2438, 2439, 2440, 2441, 2442, 2443, 2444, 2445, 2446, 2447, 2448, 2449, 2450, 2451, 2452, 2453, 2454, 2455, 2456, 2457, 2458, 2459, 2460, 2461, 2462, 2463, 2464, 2465, 2466, 2467, 2468, 2469, 2470, 2471, 2472, 2473, 2474, 2475, 2476, 2477, 2478, 2479, 2480, 2481, 2482, 2483, 2484, 2485, 2486, 2487, 2488, 2489, 2490, 2491, 2492, 2493, 2494, 2495, 2496, 2497, 2498, 2499, 2500, 2501, 2502, 2503, 2504, 2505, 2506, 2507, 2508, 2509, 2510, 2511, 2512, 2513, 2514, 2515, 2516, 2517, 2518, 2519, 2520, 2521, 2522, 2523, 2524, 2525, 2526, 2527, 2528, 2529, 2530, 2531, 2532, 2533, 2534, 2535, 2536, 2537, 2538, 2539, 2540, 2541, 2542, 2543, 2544, 2545, 2546, 2547, 2548, 2549, 2550, 2551, 2552, 2553, 2554, 2555, 2556, 2557, 2558, 2559, 2560, 2561, 2562, 2563, 2564, 2565, 2566, 2567, 2568, 2569, 2570, 2571, 2572, 2573, 2574, 2575, 2576, 2577, 2578, 2579, 2580, 2581, 2582, 2583, 2584, 2585, 2586, 2587, 2588, 2589, 2590, 2591, 2592, 2593, 2594, 2595, 2596, 2597, 2598, 2599, 2600, 2601, 2602, 2603, 2604, 2605, 2606, 2607, 2608, 2609, 2610, 2611, 2612, 2613, 2614, 2615, 2616, 2617, 2618, 2619, 2620, 2621, 2622, 2623, 2624, 2625, 2626, 2627, 2628, 2629, 2630, 2631, 2632, 2633, 2634, 2635, 2636, 2637, 2638, 2639, 2640, 2641, 2642, 2643, 2644, 2645, 2646, 2647, 2648, 2649, 2650, 2651, 2652, 2653, 2654, 2655, 2656, 2657, 2658, 2659, 2660, 2661, 2662, 2663, 2664, 2665, 2666, 2667, 2668, 2669, 2670, 2671, 2672, 2673, 2674, 2675, 2676, 2677, 2678, 2679, 26

100

Abstract

11



U.S. Department
of Transportation
**Federal Highway
Administration**

**Federal Highway Administration
California Division**

June 15, 2010

650 Capitol Mall, Suite 4-100
Sacramento CA 95814
(916) 498-5001
(916) 498-5008 fax

In Reply Refer To:
HDA-CA
File #: 414

Mr. Anthony Rizzi
California Department of Transportation
San Bernardino Field office, District 8
464 W. 4th St.
San Bernardino, Ca. 92401

Dear Mr. Rizzi:

SUBJECT: LETTER OF CONSENT – SAFETY IMPROVEMENT ON STATE ROUTE 58

Enclosed for your action is a Letter of Consent from the Field Manager of the Bureau of Land Management consenting to the appropriation and transfer of public lands of the United States within the state of California for the purpose of issuing a right -of-way use document along State Route 58 in San Bernardino County, California.

To complete this action, we ask that the necessary Highway Easement Deed now be prepared. It must include those special stipulations, appropriate mapping and legal description requested by the BLM letter of May 25, 2010. Following review by the Department's legal staff, the deed package should be forwarded to this office for review and final approval as to legal sufficiency. The deed will then be signed and accepted on behalf of the United States of America by our Division Administrator, Mr. Walter Waidehich Jr, and returned to your office for recording.

Sincerely,

For
Vincent Mammano
Acting Division Administrator





United States Department of the Interior
BUREAU OF LAND MANAGEMENT

Barstow Field Office
2601 Barstow Road
Barstow, CA 92311
www.blm.gov/ca/barstow



In Reply Refer To:
2805(P)
OACA-52003
CA-680.26

Vincent Mammano
Federal Highway Administration
California Division
650 Capitol Mall, Suite 4-100
Sacramento, CA 95814

Subject: Letter of Consent HDA-CA, File #414 -- Safety Improvements on State Route 58

Dear Mr. Mammano:

Request has been received for the appropriation of public lands of the United States within the State of California for the purpose of issuing a right-of-way use document to construct, operate, maintain, and terminate a widening of the median on State Route 58, adding rumble strips, widen and upgrade shoulders, and extend drainage, which contains 18.768 acres to the California State Highway Department pursuant to U.S.C. Title 23: Highways, Section 317.

The area requested, comprising 18.768 acres, lies in:

San Bernardino Base Meridian, San Bernardino County, California

Township 10 North, Range 6 West;
Section 2, S1/2SW1/4;
Section 3, N1/2SE1/4;
Section 4, Lots 119-130, N1/2N1/2N1/2SW1/4;

In accordance with the provisions of the Interagency Agreement between the Bureau of Land Management (BLM) and the Federal Highway Administration (FHWA), the BLM agrees to the appropriation and transfer of the above describe lands for the foregoing purposes subject to the following conditions, stipulations for which must be included in the right-of-way use document issued to the California State Highway Department, agreed upon by the State, and enforced by the FHWA:

1. If outstanding valid claims exist on the date of this use authorization, the State agency shall obtain such permission as may be necessary on account of any such claims.
2. The use right herein authorized is limited to the described right-of-way and the space above and below for highway purposes and does not include any use rights for non-highway purposes.

3. Retention of rights by BLM to use, or authorize use on, any portion of the right-of-way for non-highway purposes provided such use would not interfere with the free flow of traffic, impair the full use and safety of the highway, or be inconsistent with the provisions of Title 23 of the United States Code and the FHWA regulations pursuant thereto, and the FHWA and the State agency concerned shall be consulted prior to exercising such rights.
4. The use right herein authorized shall terminate 10 years, or sooner if agreed upon, from the date of execution of the transfer document by FHWA to the State in the event construction of a highway or use of the material site has not been initiated during such period.
5. Location by BLM of any Bureau information signs on the portions of the right-of-way outside of construction clearing limits except that such signs shall not be located on the right-of-way of an Interstate System.
6. Consistent with highway safety standards, the State agency shall:
 - a. Protect and preserve soil and vegetative cover and scenic and aesthetic values on the right-of-way outside of construction limits.
 - b. Provide for the prevention and control of soil erosion within the right-of-way and adjacent lands that might be affected by the construction, operation and maintenance of the highway.
 - c. Vegetate and keep vegetated with suitable species, all earth cut or fill slopes feasible for revegetation or other areas on which ground cover is destroyed where it is deemed necessary prior to completion of the highway and shall maintain terracing, water bars, leadoff ditches, or other preventive works that may be required to accomplish this objective. This provision shall also apply to slopes that are reshaped following slides which occur during or after construction
8. Establish no sites for highway operation and maintenance facilities, camps, supply depot or disposal areas within the right-of-way, unless shown on approved construction plans, without obtaining approval of the BLM authorized Officer.
9. Application of chemicals shall be pursuant to the National Environmental Policy Act and shall be approved by FHWA prior to application by the State.
10. The provisions of Title VI of the Civil Rights Act of 1964 (78 Stat. 242) shall be complied with.

Should you have any questions please contact Richard Rote, Realty Specialist, at (760) 252-6026.

Sincerely,

Roxie C. Trost

Roxie C. Trost
Field Manager

ROAD WIDENING FROM KERN COUNTY LINE TO 5.7 MILES EAST OF KRAMER JUNCTION

**SAN BERNARDINO COUNTY, CALIFORNIA
DISTRICT 08-SBd-SR 58-PM R0.00/R11.1
EA 08-0E8500**

Initial Study with Mitigated Negative Declaration/Environmental Assessment



**Prepared by the
State of California Department of Transportation**

The environmental review, consultation, and any other action required in accordance with applicable Federal laws for this project is being, or has been, carried out by Caltrans under its assumption of responsibility pursuant to 23 USC 327.



March 2008

SCH # 200712114
08-SBd-58-
PM R0.0/R11.1
08-0E0500

SAFETY WIDENING FROM KERN COUNTY LINE TO 5.7 MILES EAST OF KRAMER JUNCTION

Widen State Route 58 from the Kern County Line to 5.7 miles east of Kramer Junction (US-395/SR-58), to provide a 4-ft median, and 8-ft shoulders and for the installation of rumble strips.

**INITIAL STUDY with Mitigated Negative Declaration/
ENVIRONMENTAL ASSESSMENT**

Submitted Pursuant to: (State) Division 13, California Public Resources Code
(Federal) 42 USC 4332(2) (C)

THE STATE OF CALIFORNIA
Department of Transportation

3/28/08
Date of Approval

Ernest A. Figueroa
Deputy District Director
Division of Environmental Planning
California Department of Transportation, District 8

Mitigated Negative Declaration
Pursuant to: Division 13, Public Resources Code

Project Description

The California Department of Transportation (Department) plans to widen State Route 58 from the Kern County line to 5.7 miles east of Kramer Junction (the intersection of US Highway 395 [US-395] and State Route [SR-58]), to provide a 4-ft median and 8-ft shoulders and for the installation of rumble strips. The improvements are intended to reduce the high incidence of accidents at this location and to improve the overall safety of the facility.

Determination

The Department has prepared an Initial Study for this project, and following public review, has determined from this study that the project would not have a significant effect on the environment for the following reasons:

The project would have no effect on Air Quality, Farmland/Timberland, Noise, Paleontology, Community Cohesion, Hydrology and Floodplains, Water Quality, and Cultural Resources.

In addition, the project would have no significant effect on Land Use, Visual/Aesthetic Resources, Utilities, and Hazardous Waste and Materials.

The project would have no significantly adverse effect on Biological Resources, because the following mitigation measure would reduce potential effects to insignificance:

- 4.85 acres of land would be mitigated at a 3:1 ratio for a total of 14.55 acres. 8.54 acres of desert tortoise critical habitat would be mitigated at a 5:1 ratio for a total of 42.7 acres. In total, 57.75 acres of mitigation land would be purchased.

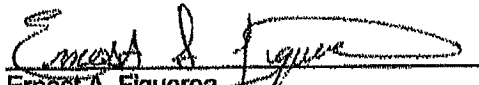
Ernest A. Figueroa
Deputy District Director
Division of Environmental Planning
California Department of Transportation, District 8

3/28/08
Date

CALIFORNIA DEPARTMENT OF TRANSPORTATION

FINDING OF NO SIGNIFICANT IMPACT

FOR

**Road Widening From Kern County Line
to 5.7 miles East of Kramer Junction
SR-58 PM R0.0 / R11.1**

The California Department of Transportation (Department) has determined that Alternative 2 will have no significant impact on the human environment. Alternative 2 consists of widening the roadbed to provide a 4-ft median, 8-ft shoulders, and installing rumble strips. In addition, existing shoulders would be widened to current standards to improve recovery zones. No improvements will be made in Kramer Junction or within 25 feet from the centerline of the BNSF Railway crossing. Temporary traffic control measures would be placed on both ends of the construction limits, with work limits of PM R0.0/R11.1.

This Finding of No Significant Impact (FONSI) is based on the attached Environmental Assessment (EA) and the associated Technical Studies, which have been independently evaluated by the Department and determined to adequately and accurately discuss the need, environmental issues, and impacts of the proposed project and appropriate mitigation measures. It provides sufficient evidence and analysis for determining that an Environmental Impact Statement (EIS) is not required. The Department takes full responsibility for the accuracy, scope, and content of the attached EA and associated Technical Studies.

The environmental review, consultation, and any other action required in accordance with applicable Federal laws for this project is being, or has been, carried-out by the Department under its assumption of responsibility pursuant to 23 U.S.C. 327.

3/28/08
Date

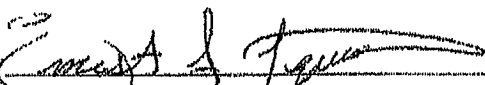
Ernest A. Figueroa
Deputy District Director
Division of Environmental Planning
California Department of Transportation, District 8

INITIAL SITE ASSESSMENT (ISA) CHECKLIST

DATE: 12/13/07 REVISED LIMITS

PROJECT INFORMATION

District 8 County SBD Rte 58 PM R0.00/R13.80 E.A 0E8500

Description of

Work: Widen Roadbed to provide a 1.5m median, standard shoulders, and install rumble strips.

Project Engineer PAT HALLY Telephone 909-388-4992
Environmental Coordinator TISA RODRIGUEZ Telephone 909-388-6310

DATE ISA NEEDED

Attach the project location map and an aerial photo to this checklist to show the location of proposed R/W and all known and/or potential hazardous waste sites.

- Project Features: New R/W? YES Excavation? YES Railroad Involvement? POSSIBLE
Structure Demolition/Modification? NO Utility Relocation? YES
- Project Setting: Rural -- YES Urban
Current Land Uses: 4-LANE HWY & 2 LANE HWY
Adjacent Land Uses: VACANT UNDEVELOPED DESERT LAND WITH SOME COMMERCIAL
(Industrial light industry, commercial, agriculture, residential, other)
- Check Federal, State, and local environmental and health regulatory agency records as necessary to see if any known hazardous waste site is in or near the project area. If a known site is identified, show its location on the attached map and attach additional sheets as needed to provide all information available pertinent to the proposed project. IS PROJECT AFFECTING SITES LISTED ON CORTESE LIST? YES IF YES, DESCRIBE SITE:
EDWARDS AIR FORCE BASE IS LISTED AS A NATIONAL PRIORITY LIST (NPL) AS A CONFIRMED SUPERFUND SITE
AS LISTED BY THE ENVIRONMENTAL PROTECTION AGENCY.

5. Conduct Field Inspection Date

Storage Structures/Pipelines:				Contamination: (spills, leaks, illegal dumping, etc)		Hazardous Materials: (asbestos, lead, etc.)	
UST's	NO			Surface Staining	NO	Buildings	NO
Surface tanks	NO			Oil Sheen	NO	Sprayed-on Fireproofing	NO
Sumps	NO	Ponds	NO	Odors	NO	Pipe Wrap	NO
Drums		Basins	NO	Vegetation damage	NO	Friable Tile	NO
Transformers	YES			Other		Acoustical Plaster	NO
Landfill	NO					Serpentine	NP
Other						Paint	YES Other

Other comments and/or observations

SOILS ARE NON HAZARDOUS WITH RESPECT TO AERIAL DEPOSITED LEAD (SEE ATTACHED MEMO)
USE SSP 15-300 FOR YELLOW THERMOPLASTIC AND WHITE STRIPE REMOVAL IF NEEDED, REQUIRES HQ APPROVAL, PE SHALL EDIT SUBMIT TO R. ROA FOR HQ APPROVAL.
ACQUISITION OF EDWARDS AIR FORCE BASE AND/OR GASOLINE SERVICE STATIONS IS NOT ADVISED.
ADDITIONAL HAZARDOUS WASTE ASSESSMENT WILL BE NECESSARY IF THESE AREAS ARE IMPACTED BY PROJECT.

ISA DETERMINATION:

Does the project have potential hazardous waste involvement? LOW RISK

If there is known or potential hazardous waste involvement, is additional ISA work needed before task orders can be prepared for the Preliminary Site Investigation? If yes, explain, and give estimate of additional time required

ISA CONDUCTED/CONCURRED BY: Rosanna Roa DATE: 12/13/07

ROSANNA ROA, MS 824
DISTRICT 8 HAZARDOUS WASTE COORDINATOR
909-383-5917